

## Exhaust Head Series "Cyclone"



### Cyclonic Action

- Spins out entrained water, oil and dirt leaving only clean, dry exhaust.

### Noise Reduction

- Large exhaust opening reduces velocity and minimizes exhaust noise and does not produce back pressure.

### Line Protection

- Cyclone exhaust head "Spiral Baffle" protects exhaust line from entry of rain, snow and dirt directing them to the drain.

### How it works

Water and Oil entrained in Exhaust Steam and Gases may cause damage to roofs and sidewalls and unsightly icing and dirt accumulation. The spiral baffles swirl the steam or exhaust gases and the resulting CYCLONIC ACTION throws the entrained water, oil and dirt to the outside of the cyclone where it is directed to the exhaust head drain.

### Quality Construction

All surfaces of the Exhaust Head slant toward the drain so that THE UNIT IS SELF-DRAINING AND SELF-CLEANING REQUIRING LITTLE OR NO MAINTENANCE. The vessel walls are constructed of 3/16" or 5/16" carbon steel. With all external and internal surfaces painted with high-heat, rust-resistant paint, the Alstrom Cyclone Exhaust Head is constructed for many years of trouble free service. Its symmetrically streamlined design combines modern appearance with design efficiency.



## Exhaust Head Series "Cyclone"

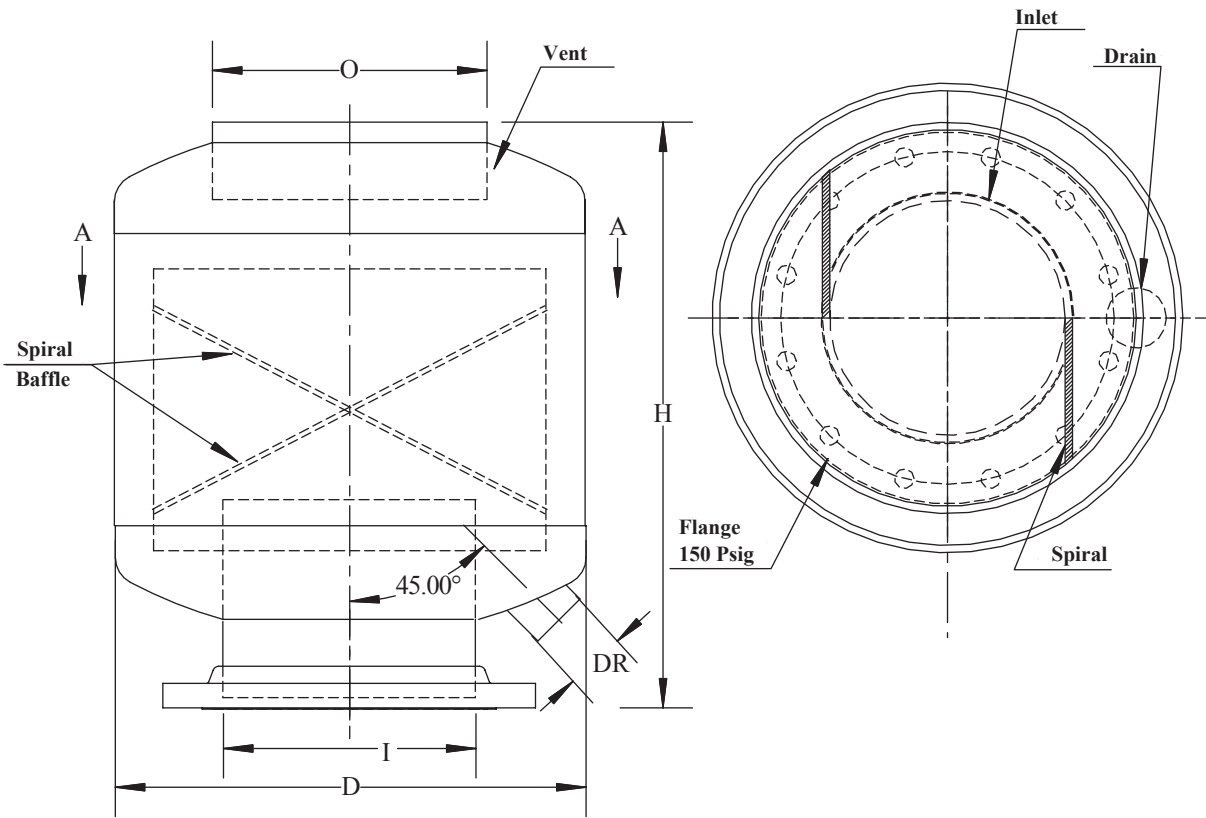

MODEL NO.	"I" INLET	"O" OUTLET	"DR" DRAIN	"D" DIAMETER	"H" HEIGHT	STEAM #/HR	AIR SCFM	WEIGHT LBS
EX 10-2	2"	6"	3/4"	10"	21"	645	280	85
EX 10-2.5	2 1/2"	6"	3/4"	10"	21"	920	400	90
EX 10-3	3"	6"	3/4"	10"	21"	1420	615	95
EX 10-4	4"	6"	1"	10"	21"	2450	1060	105
EX 14-5	5"	8"	1 1/2"	14"	21"	3845	1665	140
EX 14-6	6"	8"	1 1/2"	14"	21"	5540	2400	160
EX 20-8	8"	10"	2"	20"	26"	9610	4165	310
EX 20-10	10"	12"	2"	20"	26"	15150	6565	330
EX 24-12	12"	14"	3"	24"	30"	21325	9240	485
EX 24-14	14"	16"	3"	24"	30"	26000	11270	525
EX 26-16	16"	18"	3"	26"	38"	34000	14725	685
EX 36-18	18"	20"	3"	36"	54"	45000	19500	1130
EX 42-20	20"	24"	3"	42"	58"	54000	23160	1800
EX 42-24	24"	30"	3"	42"	58"	69000	29880	1875
EX 48-30	30"	36"	4"	48"	65"	120000	51600	2035
EX 54-36	36"	42"	4"	54"	75"	188000	81240	2710

To size the cyclone exhaust head use the discharge line size to select inlet dimension ( I ) above.  
Check the maximum flow rate capacity to the actual flow rate. Select a larger size for high capacities as required.